

Cam switches

Complete switches and adaptable sub-assemblies, 12 and 20 A

The cam switch range comprises the equally dimensioned and similar looking products of the K1 (12 A rating) series and K2 (20 A rating) series. Both series feature complete switches and adaptable sub-assemblies for user assembly.

Complete switches

Front mounting

- switches
- stepping switches (2 to 5 step)
- reversing and 1 to 4-pole changeover switches
- ammeter and voltmeter switches

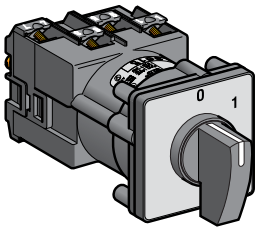

"Multi-fixing"

K1 ● ● ● ● ● H, **K2** ● ● ● ● ● H

See pages 30048-EN/2 to 30048-EN/9

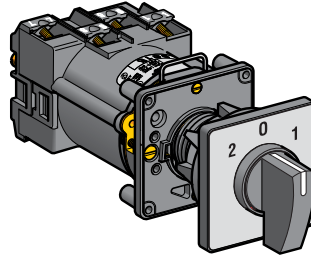

By Ø 22 mm hole

K1 ● ● ● ● ● H, **K2** ● ● ● ● ● H

See pages 30048-EN/2 to 30048-EN/9

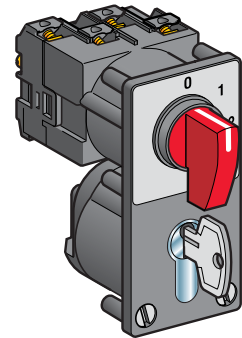

Front mounting by 6 screws Ø 5.2 mm and 55 x 100 mm front plate

K1 ● ● ● ● ● Z ●

See pages 30053-EN/2 to 30053-EN/7

Switches for user assembly

Front mounting

Body sub-assembly

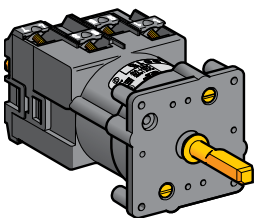

Head sub-assembly

- With 45 x 45 mm front plate and 35 mm handle



With blank legend

K ● G 3H

See page 30033-EN/2

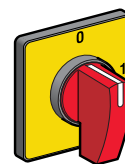

With marked legend

K G 3H

See page 30033-EN/2

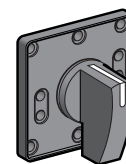

Without legend

K D G 3H

See page 30033-EN/2

"Multi-fixing"

K1 ● ● ● ● ● L, **K2** ● ● ● ● ● LL

See pages 30049-EN/2 to 30049-EN/33

Head sub-assembly

- With 45 x 45 mm front plate, 35 mm handle and padlocking device

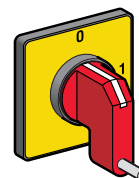

With marked legend

K G 3Y

See page 30033-EN/2

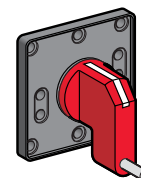

Without legend

K D G 3Y

See page 30033-EN/2

Cam switches

Complete switches and adaptable sub-assemblies, 12 and 20 A

Switches for user assembly (continued)

Front mounting (continued)

Body sub-assembly

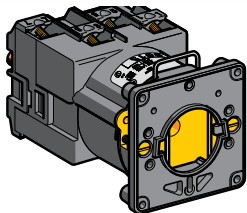

With Ø 22 mm hole

K1●●●●●●, K2●●●●●●L

See pages 30049-EN/2 to 30049-EN/33

Head sub-assembly

■ With 45 x 45 mm front plate and 35 mm handle

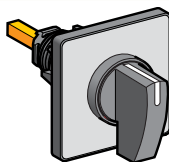

With blank legend

K●C 1H

See page 30033-EN/2

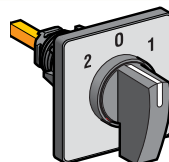

With marked legend (1)

K●C 1●●

See page 30033-EN/2

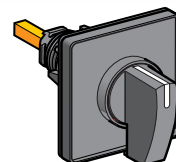

Without legend

KDC 1●●

See page 30033-EN/2

Head sub-assembly

■ With 45 x 45 mm front plate and key operator

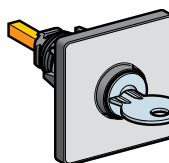

With blank legend

K●C 1●●

See page 30033-EN/2

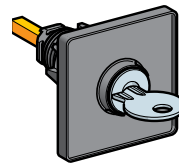

Without legend

KDC 1●●

See page 30033-EN/2

Head sub-assembly

■ With 60 x 60 mm front plate and 42 mm handle

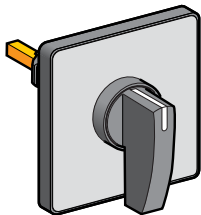

With blank legend

K●D 1H

See page 30033-EN/2

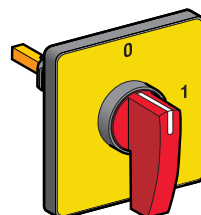

With marked legend

KCD 1MH

See page 30033-EN/2

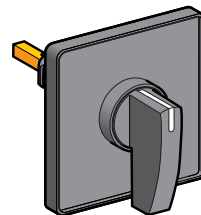

Without legend

KDD 1H

See page 30033-EN/2

Head sub-assembly

■ With 60 x 60 mm front plate and key operator

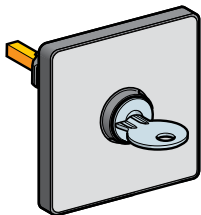

With blank legend

K●D 1●●

See page 30033-EN/3

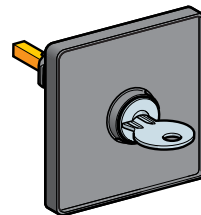

Without legend

KDD 1●●

See page 30033-EN/3

Head sub-assembly

■ Circular with plastic bezel



Key operator

K●A 1●●

See page 30033-EN/3

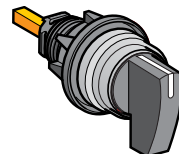

35 mm handle

K●A 1H

See page 30033-EN/3

(1) With or without padlocking device.

Cam switches

Complete switches and adaptable sub-assemblies, 12 and 20 A

Switches for user assembly (continued)

Front mounting (continued)

Body sub-assembly

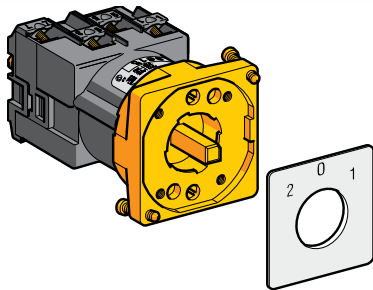

With Ø 22 mm hole and metal mounting plate

K1 ● ●●●●K, **K2** ● ●●●●X

See pages 30049-EN/2 to 30049-EN/33

Head sub-assembly

- Circular with metal bezel



Standard handle

KAX Z1M1 ●

See page 30033-EN/3

Long handle

KAX Z1C1 ●

See page 30033-EN/3

Key operator

KAX Z1S1 ●●

See page 30033-EN/3

Rear mounting

Body sub-assembly

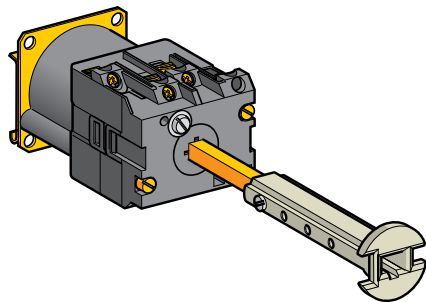

With 4 holes

K1 ● ●●●●, **K2** ● ●●●●

See pages 30049-EN/2 to 30049-EN/33

Head sub-assembly

- With 45 x 45 mm front plate and 35 mm handle

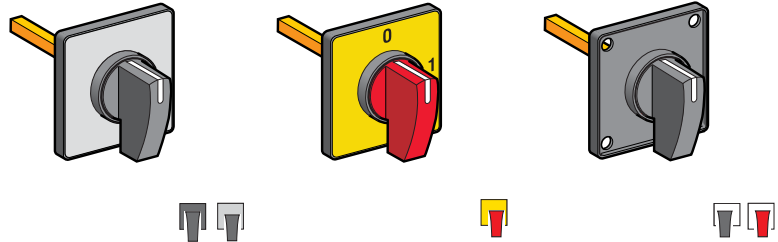

With blank legend

KoE 1H

See page 30033-EN/3

With marked legend (1)

KCE 1 ●

See page 30033-EN/3

Without legend

KDE 1 ●

See page 30033-EN/3

Head sub-assembly

- With 60 x 60 mm front plate and 42 mm handle

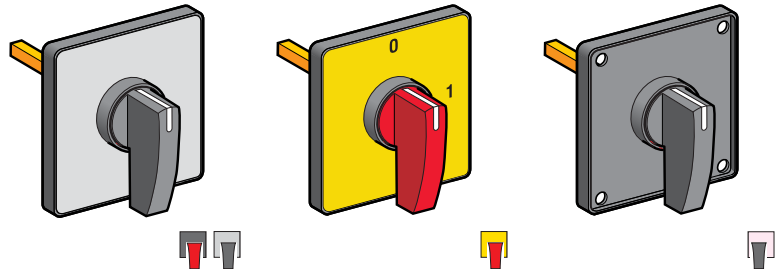

With blank legend

KoF 1H

See page 30033-EN/3

With marked legend

KCF 1MH

See page 30033-EN/3

Without legend

KDF 1H

See page 30033-EN/3

(1) With or without padlocking device.

Accessories

Various accessories complement the K1 - K2 cam switch range: legends, legend holders, terminal covers, seals, etc. See pages 30035-EN/2 to 30034-EN/3.

Switches with specific schemes

If you cannot find a standard switching programme listed in this catalogue to suit your application, please consult your Regional Sales Office.

Cam switches

Complete switches and adaptable sub-assemblies, 12 and 20 A

The cam switches are available to suit various mounting and fixing methods.

Fixing

Front mounting

By means of "multi-fixing" front plate, using 2 or 4 screws

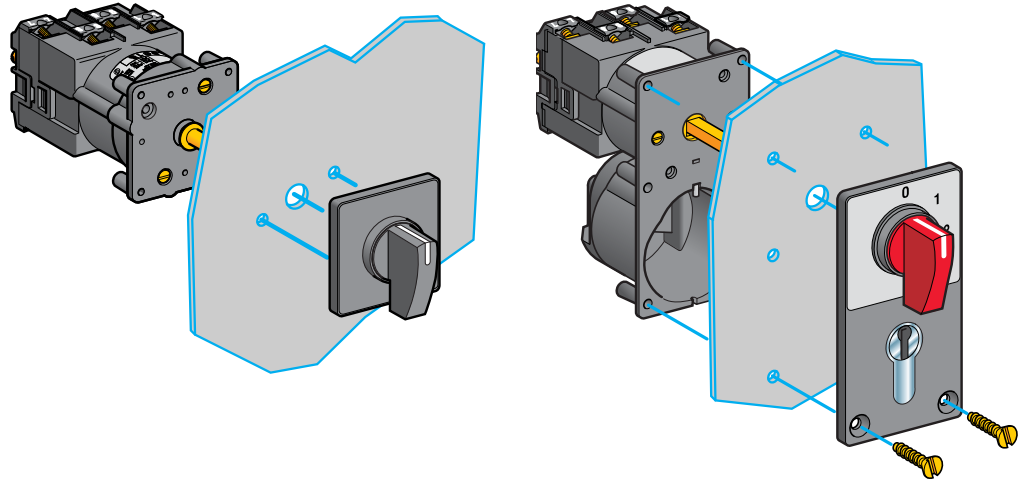
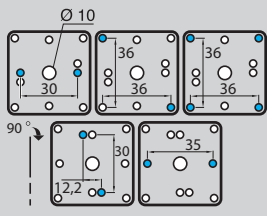

The "multi-fixing" concept enables the switch to be panel mounted using the most commonly used fixing centre dimensions. See drawing to left.

Fixing by 6 screws \varnothing 5.2 mm and 55 x 100 mm front plate.

By means of single \varnothing 22 mm hole

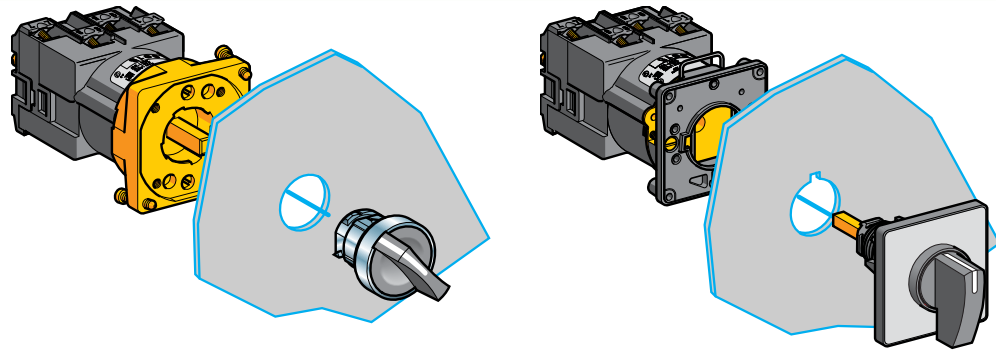

\varnothing 22.5 mm cut-out.
Head attaches to plate using 1/4 turn bayonet locking and secured on panel by 2 needle screws.

\varnothing 22.5 mm cut-out with anti-rotation notch.
Head clips into body and secured on panel by fixing nut.

Rear mounting

By means of 4 holes

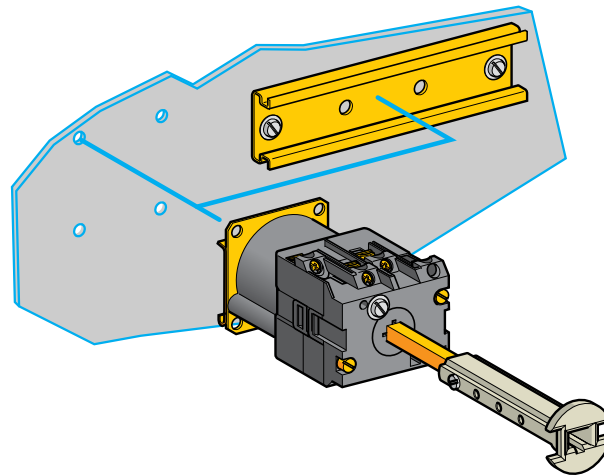

Switch can be directly mounted on backplate using 4 screws.
For DIN rail mounting, an adaptor is available as an accessory. See page 30034-EN/3.